

Single Motor Electric Height Adjustable Desk

InstructionManual

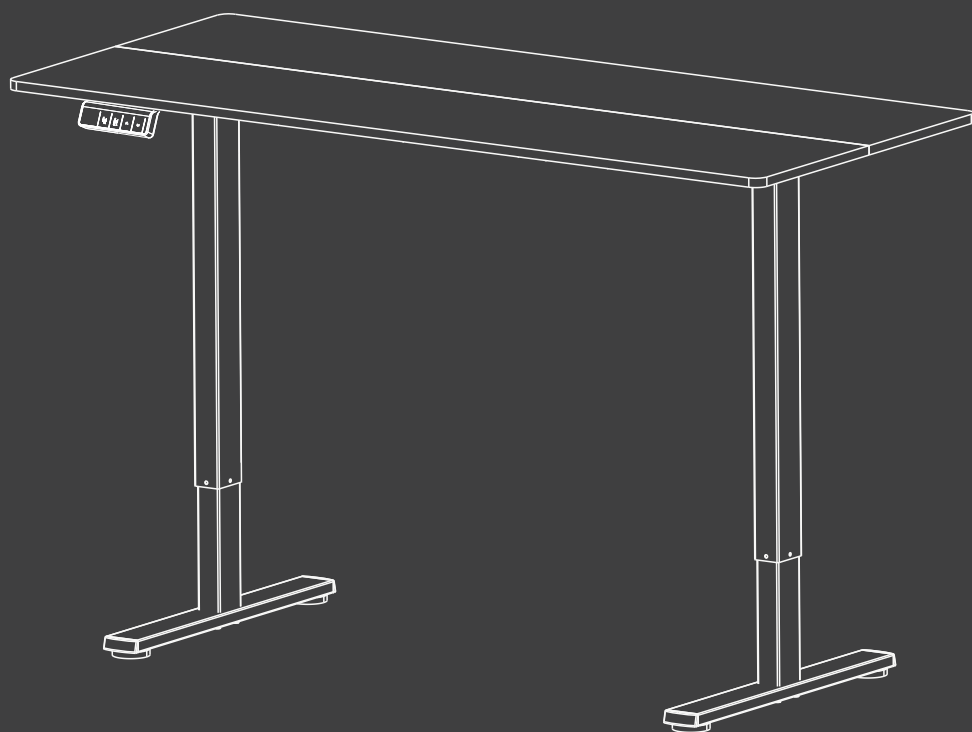

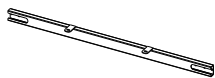

1 x1

Beam

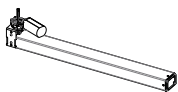

2 x1

Left Leg



3 x1

Right Leg



4 x1

Drive Rod

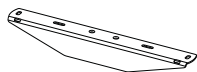

5 x2

Side Plate

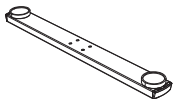

6 x2

Leg Base



7 x2

Board



8 x1

Hand Controller

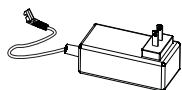

9 x1

Power Supply



10 x5

Desk Connection Plate



11 x4

Wooden Pin



12 x10

Silicone Sheet



13 x3

Cable Clip



M-A x1

Screws



M-B x4

Screws



M-C x8

Screws



M-D x22

Screws



M-E x4

Screws



M-F x3

Screws



M-G x1

Wrench



M-H x1

Wrench

Please read the installation instructions carefully
before installation

Step 1

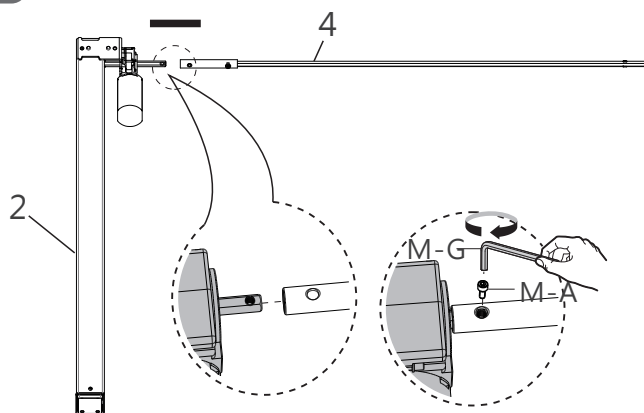

Align the holes of Left Leg (2) and Drive Rod (4), Using Wrench (M-G) to secure both with Screw (M-A).

Step 2

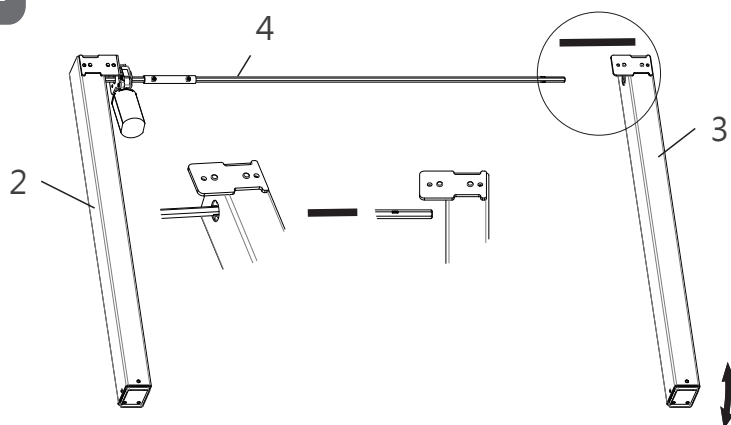

Insert Drive Rod (4) into the hole of Right Leg (3). If it cannot be inserted tilt Right Leg (3) slightly until they're matched.

Step 3

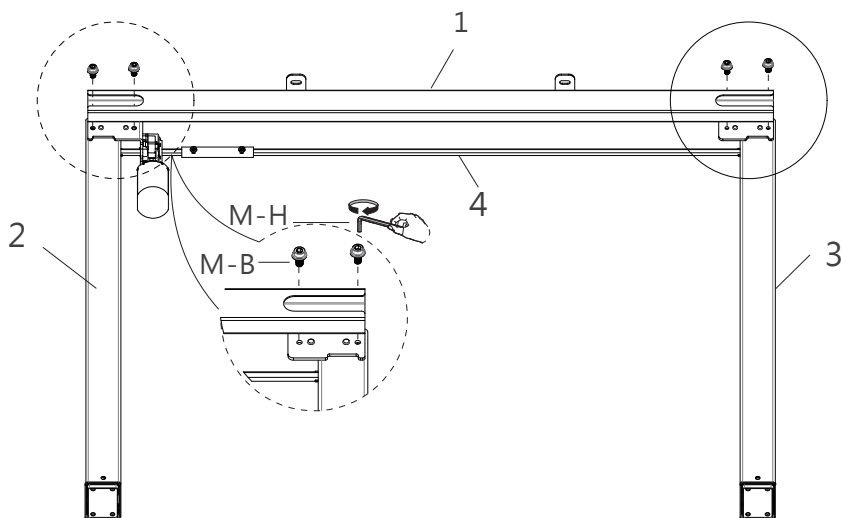

As shown, use Wrench(M-H), install Beam(1) to the Legs(2&3) with Screws(M-B)*4

Step 4

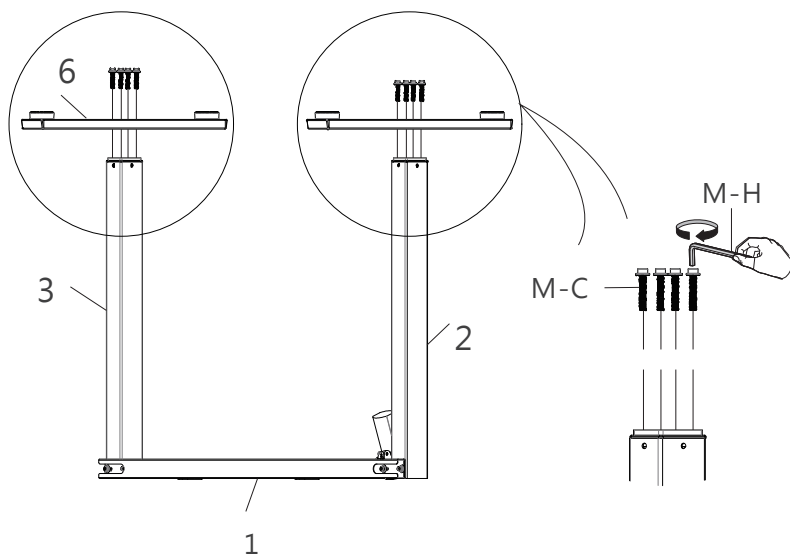

Using Wrench(M-H), install Leg Base(6)*2 to the Legs (2&3) respectively with Screws (M-C)*8

Step 5

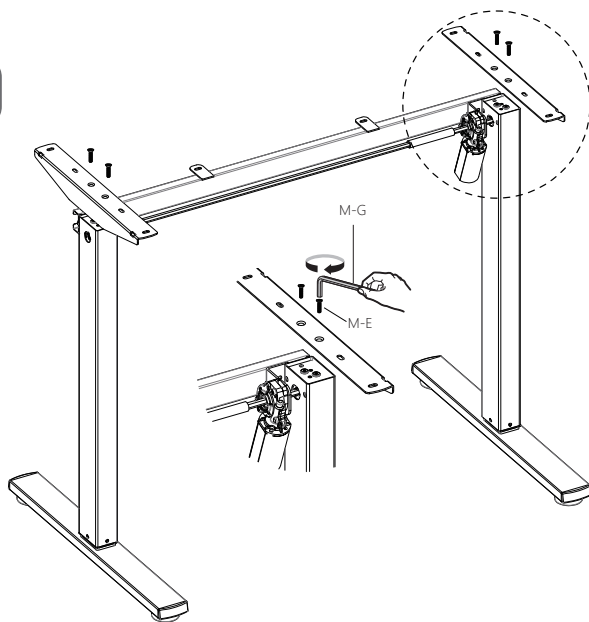

Use screwdriver, install Side Plate(5)*2 on each side of the Legs (2&3) with Screws (M-E)*4

Step 6

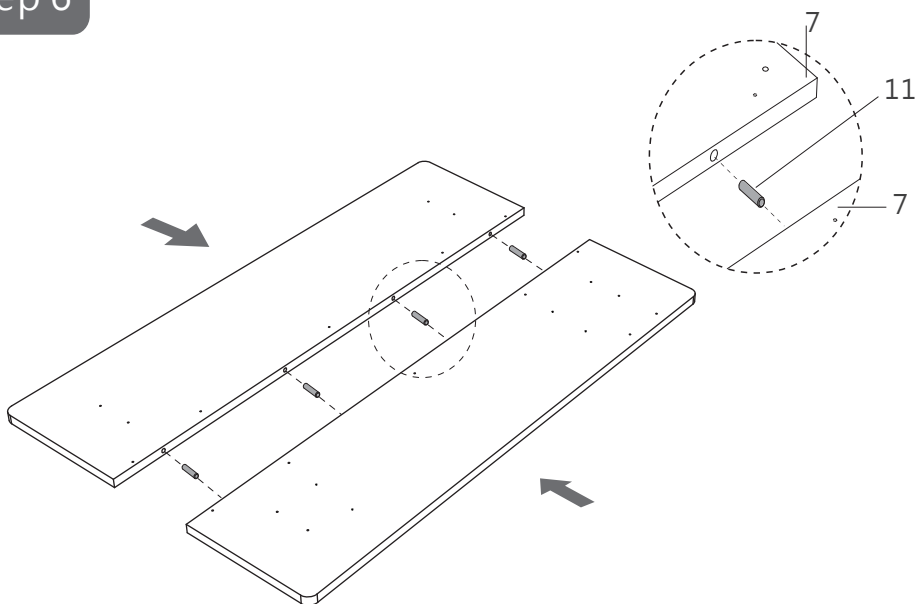

Step 7

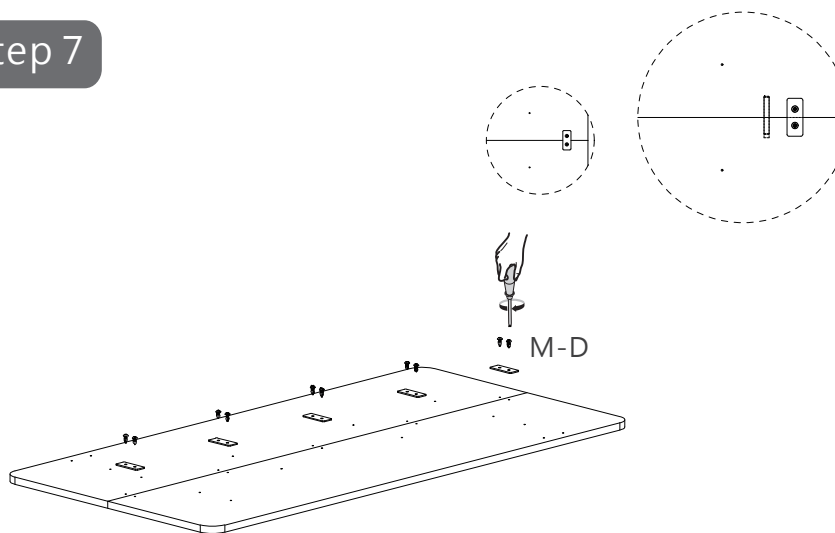

Fix Boards (7*2) with Wooden Pin(11)*4. Use screwdriver, with Screws (M-D)*10, install Desk Connection Plate(10)*5 to the middle of the Boards.

Step 8

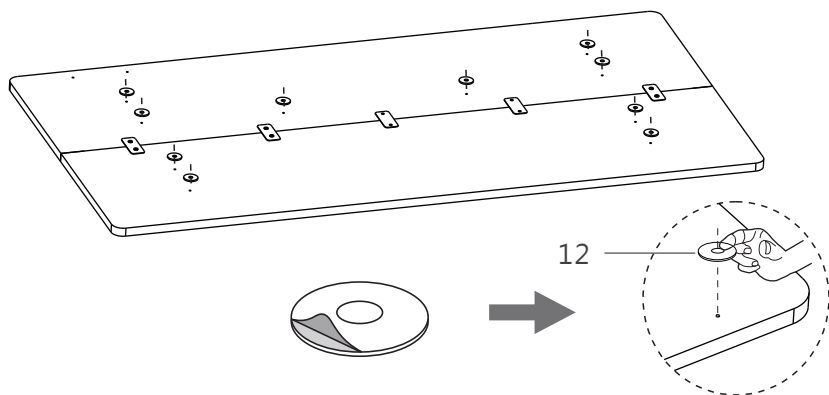

Remove the sticker from the Silicone Sheet(12)*10, Fix Silicone Sheet (12)*10 to the corresponding position on the Boards(7*2).

Step 9

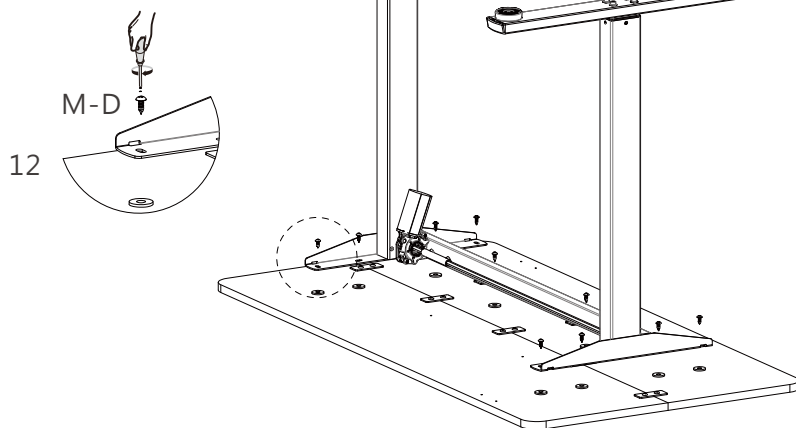

Use screwdriver, secure the Leg part to the Boards(7*2) with Screws (M-D)*10.
Please align the Silicone Sheet (12)*10.

Step 10

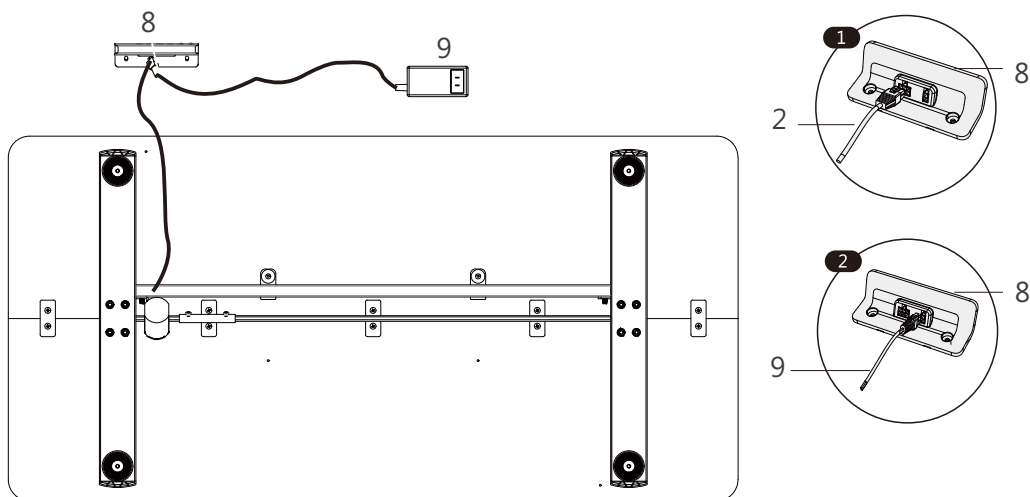

As shown, connect the motor at the Left Leg(2), Hand Controller(8)
and Power Supply(9) in turn.

Step 11

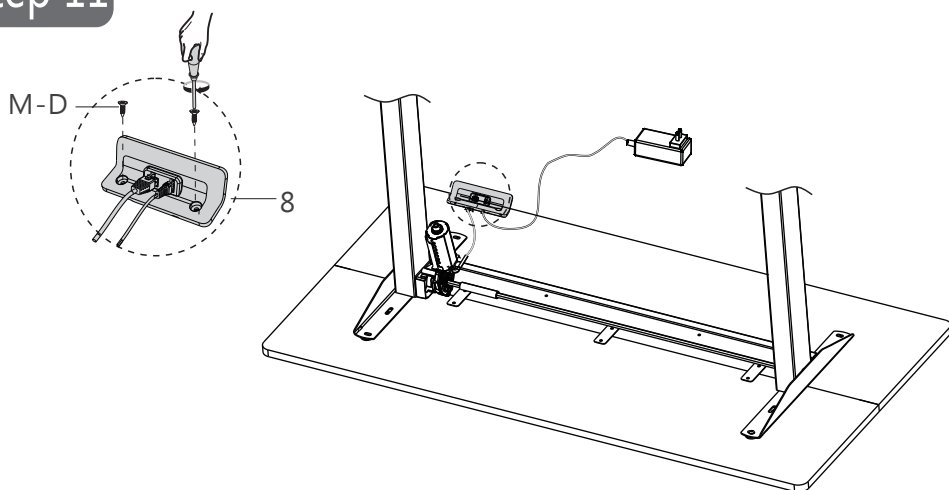

Using screwdriver, install Hand Controller(8) to the Board Screws (M-D)*2.

Step 12

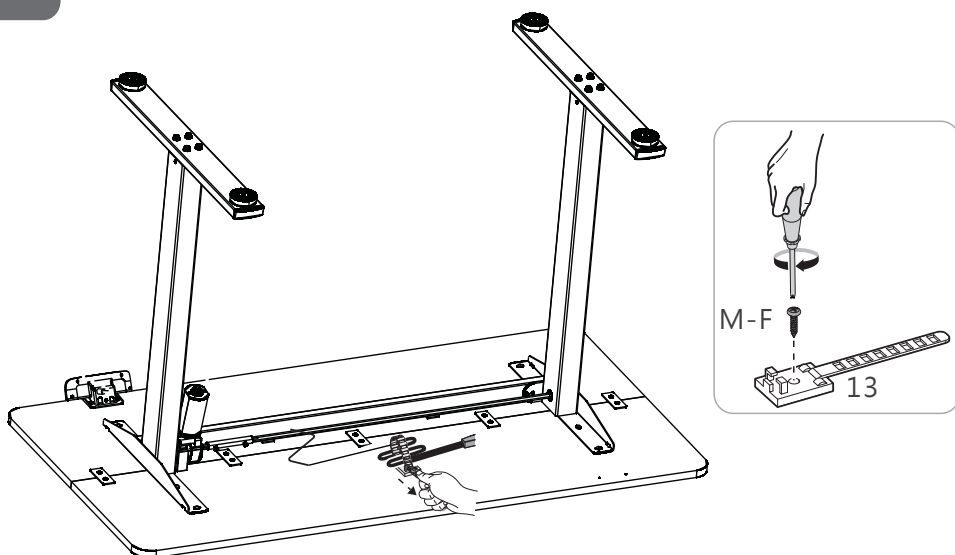

Run the cables through the Cable Clips (13) and attach the Cable to the desktop with Screws (M-F) to ensure clean and neat surface.

User Guide

1、 Operation Panel:



Note: The silk-screen printing of the buttons shall be subject to the actual product.

2、 Powered on for the first time:

Connect the controller to the power adapter according to the nameplate on the controller, and the controller will display the current height. If the displayed height value does not match the actual height of the lifting legs, or if the height of the lifting legs has been changed after reinstallation, a reset operation is required. Otherwise, it can be used directly according to the factory preset settings.

3、 Reset :

Press "⬇️", until 5 seconds after the lifting leg stops. At this time, the controller displays "rst", indicating that the reset is in progress. At this time, do not release the "⬇️". When the lifting leg descends slowly until it reaches the lowest position and automatically rebounds for a certain distance, then release the button. This indicates that the reset operation is completed.

If any unexpected issues occur during the reset process, you can release the "⬇️" key at any time. The lifting legs will stop running, and the reset process will terminate. After the reset is terminated, you must perform the reset operation again until it succeeds. Otherwise, you won't be able to carry out other operations.





4、 Upward Operation:

Press and hold the "⬆️" key on the controller, and the lifting table will rise. Release the key, and it will stop.





5、 Downward Operation:

Press and hold the "⬇️" key on the controller, and the lifting table will descend. Release the key, and it will stop.





6、Memory Height Setting:





When the lifting legs are in a stopped state, long - press either the "  " or "  " button for 5 seconds, and the controller will display "S - X" (where X is the sequence number of the corresponding button). At this time, the current height position of the lifting leg is saved to the corresponding button. The controller can remember 2 height positions in total, and they can be repeated. The memory is retained even after a power outage. After the memory position is set, simply short - press either the "  " or "  " button, and the lifting table will automatically position to the memorized position of the corresponding button. During the process of the lifting table positioning to the memory position, pressing any button can stop the operation.



7、Child Lock:

Press and hold the "  " and "  " keys simultaneously for 5 seconds. When the controller displays "LOC", it indicates that the system is locked and the lifting operation of the system cannot be performed. In the locked state, press and hold the "  " and "  " keys simultaneously again for 5 seconds. When the display on the controller changes from " LOC" to the normal digital display, it indicates that the system has been unlocked.

9、Menu Option Operations:

Press and hold the "  " and "  " keys on the controller simultaneously for 5 seconds to enter the menu options, and the menu content will flash. There are seven menu items in total, namely Minimum Height Setting, Maximum Height Setting, Basic Height Setting, Upward Sensitivity Setting of Obstacle - Protection Current, Downward Sensitivity Setting of Obstacle - Protection Current, Tilt Sensor Sensitivity Setting, and Display Unit Setting. Press the "  " and "  " keys simultaneously and briefly to cycle through the menu pages.

Press the "  " and "  " keys briefly to modify the menu content. When setting the minimum height and maximum height, you can press and hold the "  " and "  " keys to quickly modify the menu content.

Press and hold the "  " and "  " keys simultaneously, and a right - scrolling progress bar will appear. When the progress bar reaches the end, all the current menu content will be saved. If the save is successful, "SUS" will be displayed; if it fails, "FAL" will be shown. Then, you will exit the menu. If there is no operation for 10 seconds, it will automatically exit the menu mode.

Menu options	Display	Remark
Minimum Height	73~108CM	The setting value should be at least 10 cm less than the Maximum Height
Maximum Height	83~118CM	The setting value should be at least 10 cm more than the Minimum Height
Board Basic Height Setting	0~30CM	The adjustable unit is 1 centimeter.
Upward Anti-Collision	PC0 ~ PC5	Range: 0 ~ 5 0: Shut down; 1 ~ 5: The higher the number, the higher the sensitivity
Downward Anti-Collision	dC0 ~ dC5	Range: 0 ~ 5 0: Shut down; 1 ~ 5: The higher the number, the higher the sensitivity
Display Unit	U-0	Change the numeric display to show heights in centimeters
	U-1	Change the numeric display to show heights in inches
Note: The values in the above menu are neutral default values, and the values for different customers may vary.		

10、Power-Saving Mode:

The screen will turn off if there is no button-press for a minute. Any button-press will turn the screen on again.

11、Description:

Description	Code	Troubleshooting Solution
Abnormal Standby Current	SC0	Power on again. If the code persists, replace the Control box.
Abnormal Power Supply Board	SC1	Power on again. If the code persists, replace the Control box.
Abnormal Sensor	SC3	Power on again. If the code persists, replace the Control box.
Abnormal Voltage	SC4	Power on again. If the code persists, replace the Control box.
Desktop Tilt Alarm	R-2	When the desktop tilt alarm is triggered, the device will run in the reverse direction for 5 cm and then stop. After the alarm recovers automatically, the actual height value of the desktop will be displayed.
Sync Failed	R-3	Try the reset operation to eliminate the fault code
Thermal Protection	HOT	When the system overheats, it will automatically enter the protection state. The alarm will automatically disappear 18 minutes later.
Communication Failure	R-5	Check the connection between Handset and Control Box or replace Handset.
Abnormal Voltage	R-6	Power on again. If the code persists, replace the Control box.
Incomplete Reset	RST	Continue the reset operation.
Abnormal Circuit	EX0	Power on again. If the code persists, replace the Control box.
Overload Protection	EX1	Operation is prohibited when in the overload protection state. The alarm will automatically disappear after 20 seconds. If you want to run it again, you need to reduce the load or check whether there are any mechanical failures in the lifting mechanism.
Motor phase loss	EX2	Check whether the motor wires are properly connected. Re-plug the motor wires and perform the reset operation. If the alarm persists, replace the hand controller or the motor wires.
Abnormal Motor Hall Signal	EX3	Check if the motor wires are connected properly. Unplug and replug the motor wires, then carry out the reset operation. If the alarm still doesn't go away, replace either the hand controller or the motor wires.
Retreat Alarm upon Obstacle Encounter	EX4	When the obstacle protection is triggered, the lifting leg will immediately move in the opposite direction for 5 cm and then stop, and the alarm will automatically be eliminated.
Unconnected Motor Wire	EX6	Check whether the motor wires are properly connected. Unplug and replug the motor wires. If the alarm persists, replace the hand - controller or the motor wires.
Mechanical Malfunction	EX7	Check whether there are any abnormalities in the structure of the lifting leg or the motor.

Remarks: X represents the table leg number 1, 2, 3,...