

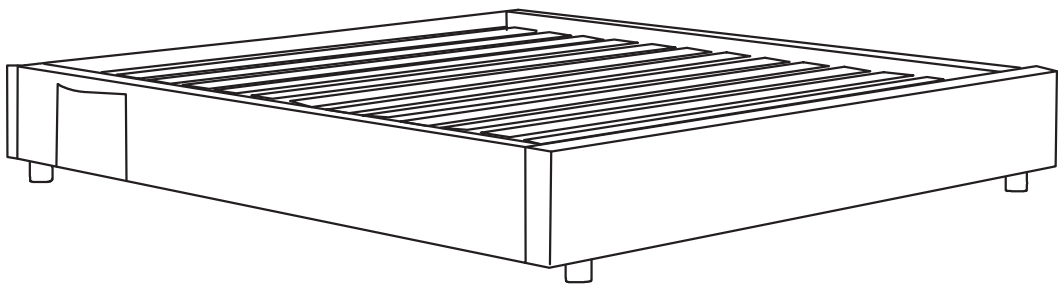

## Elise Bed Base



## Assembly Instructions

- **ASSEMBLY REQUIREMENT**

1. 2 PERSON ASSEMBLY | 20 MINUTES ASSEMBLY TIME (APPROXIMATE)

- **TOOLS REQUIRED**

1. No Tools

- **ASSEMBLY PREPARATION**

1. Remove all packaging materials, staples and packing straps from the carton.
2. Refer to Parts Checklist and ensure they are complete before you start assembling.
3. Place all components on a clean, flat and soft surface (e.g. carpet or rug) to prevent parts from getting scratched or dirty.

- **TIPS FOR ASSEMBLY**

1. Allow ample room for assembly and in close proximity to where product will be placed.
2. Assemble the product on a surface that does not scratch or damage the exterior and finish of the furniture
3. During assembly, do not over-tighten any fittings as this may cause damage.
4. Do not use power tools to assemble this product.
5. Do not sit or stand on the partially assembled product, only use the product for which it is intended.

- **CARE AND USE**

- Avoid placing bed in direct sunlight
- Vacuum regularly on low suction
- Blot spills immediately with an absorbent towel or clean, damp cloth
- Spot clean with upholstery shampoo, mild detergent or a mild cleaning solvent
- Avoid scrubbing and the use of harsh detergents

### **SAFETY PRECAUTIONS:-**

1. KEEP ALL HARDWARE PARTS OUT OF REACH OF CHILDREN AND ANIMALS.
2. DISPOSE PLASTIC PACKAGING MATERIAL IMMEDIATELY TO AVOID ANY RISK OF SUFFOCATION

## PARTS CHECK LIST

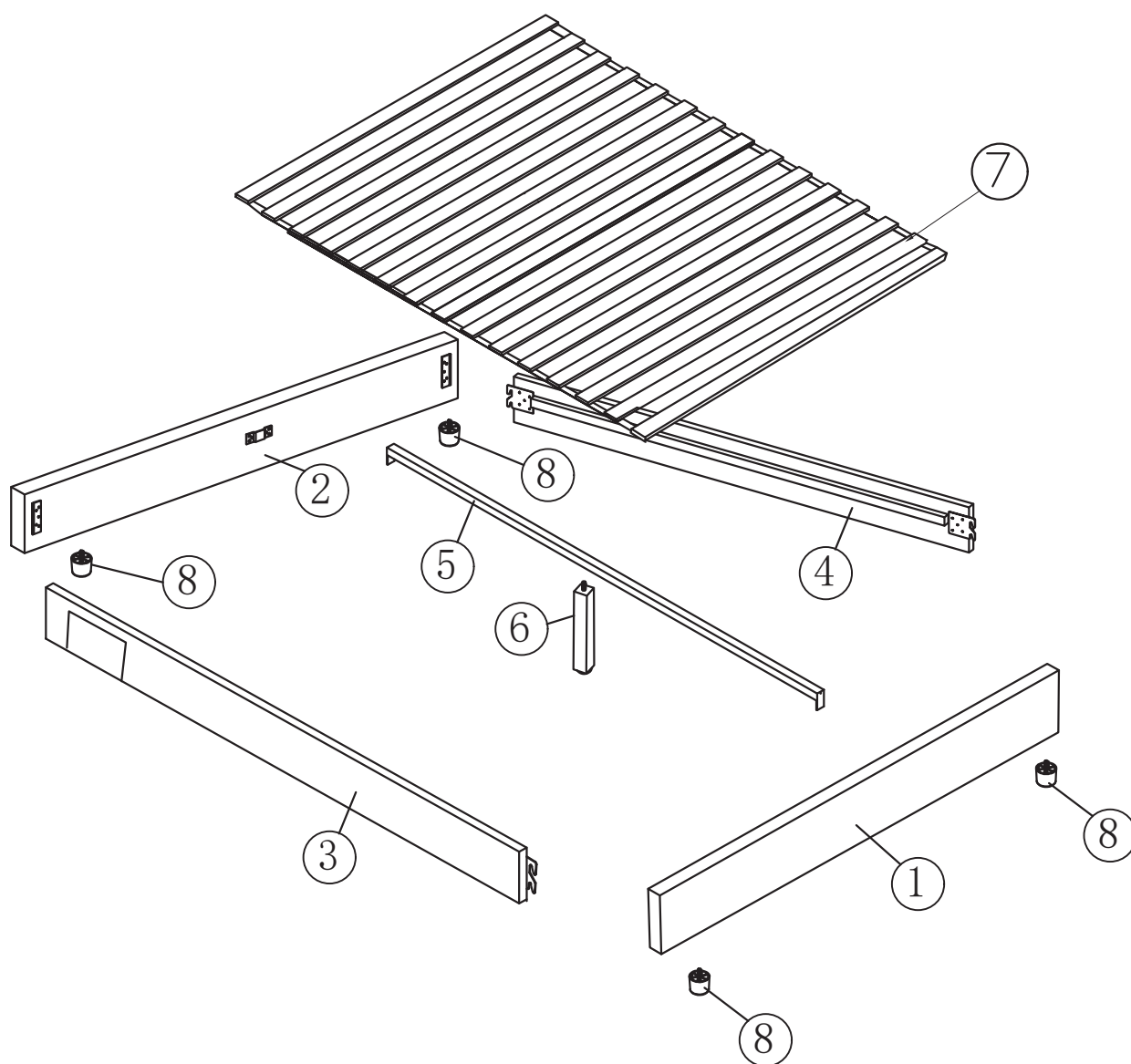

- |         |         |          |          |
|---------|---------|----------|----------|
| ① =1 PC | ② =1 PC | ③ =1 PC  | ④ =1 PC  |
| ⑤ =1 PC | ⑥ =1 PC | ⑦ =1 SET | ⑧ =4 PCS |

## Step-1

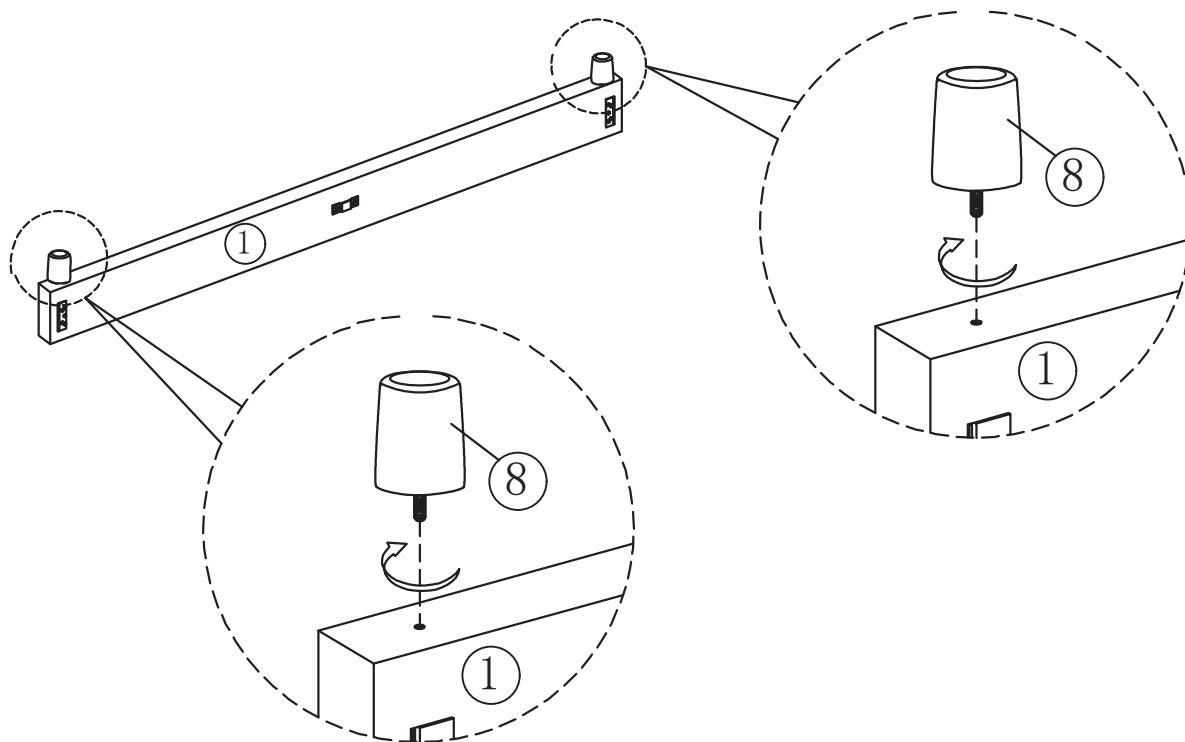

## Step-2

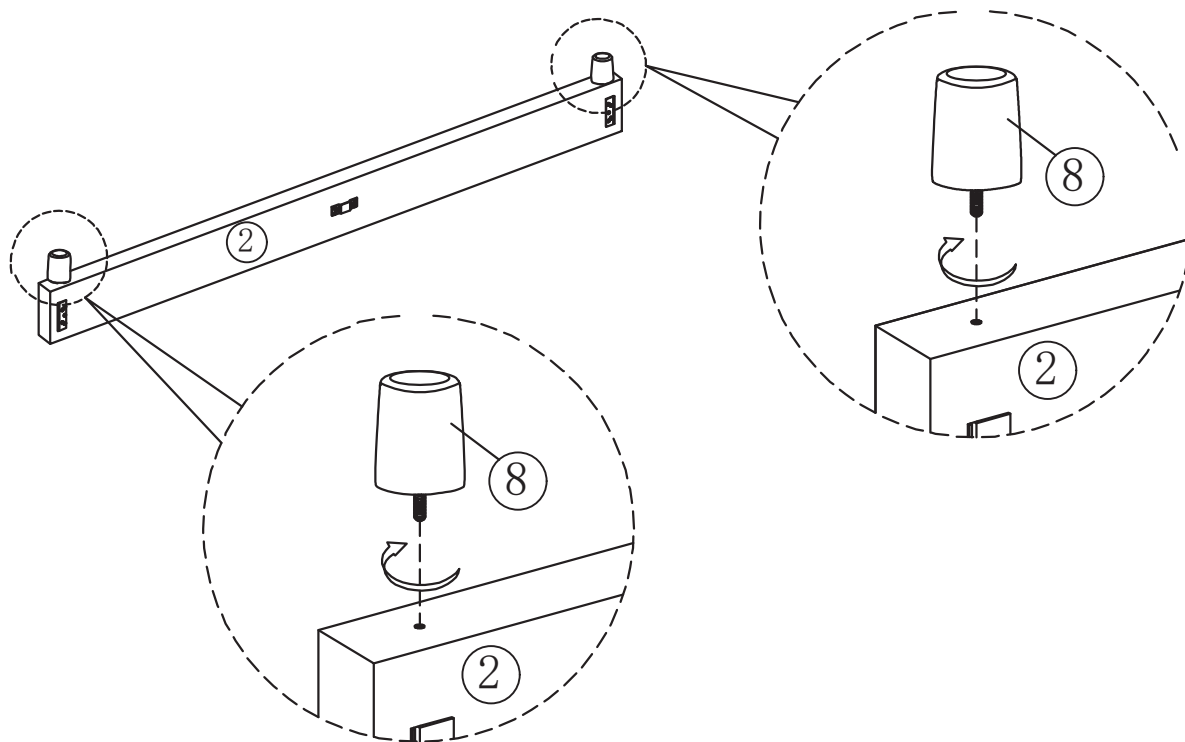

## Step-3

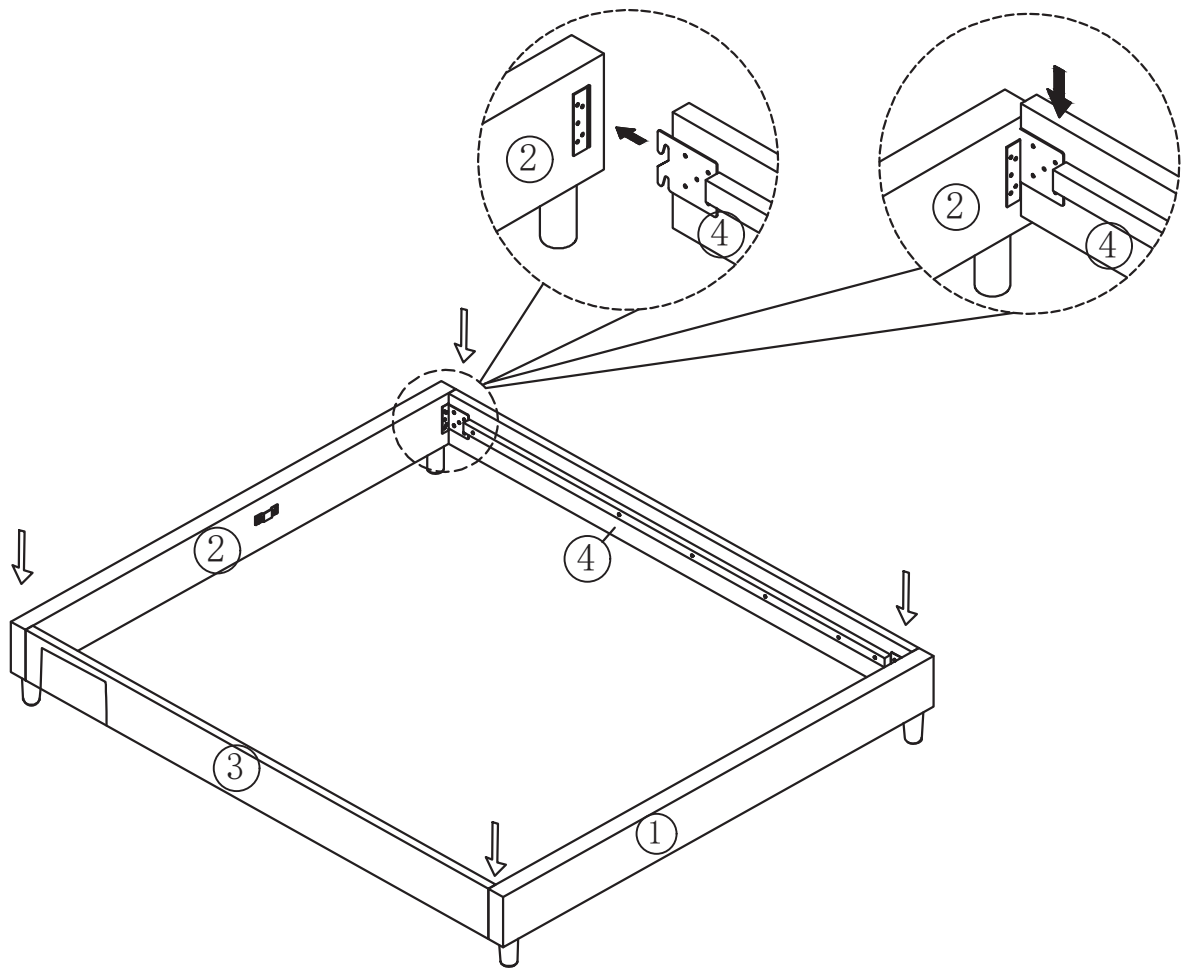

## Step-4

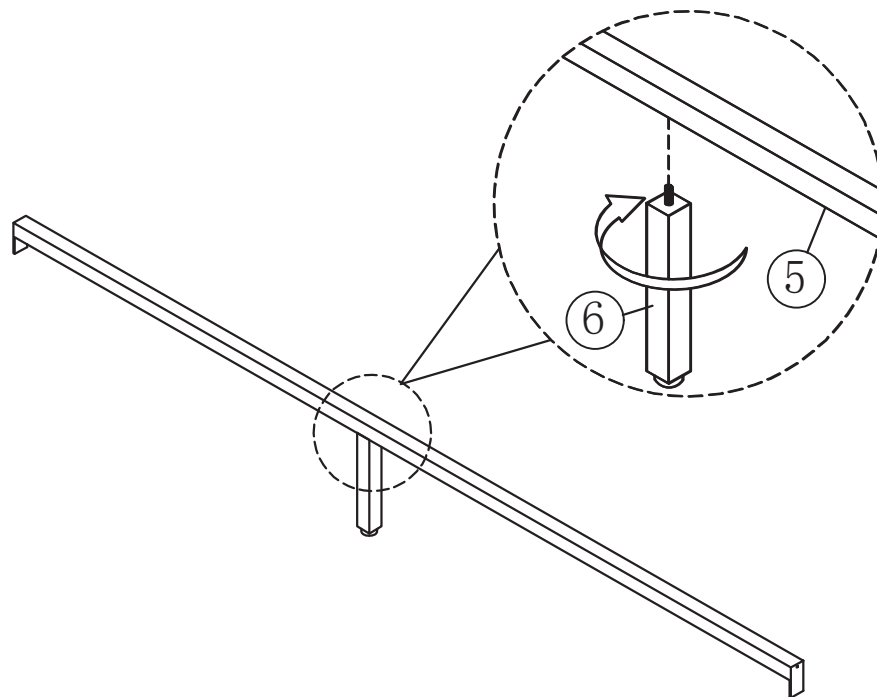

## Step-5

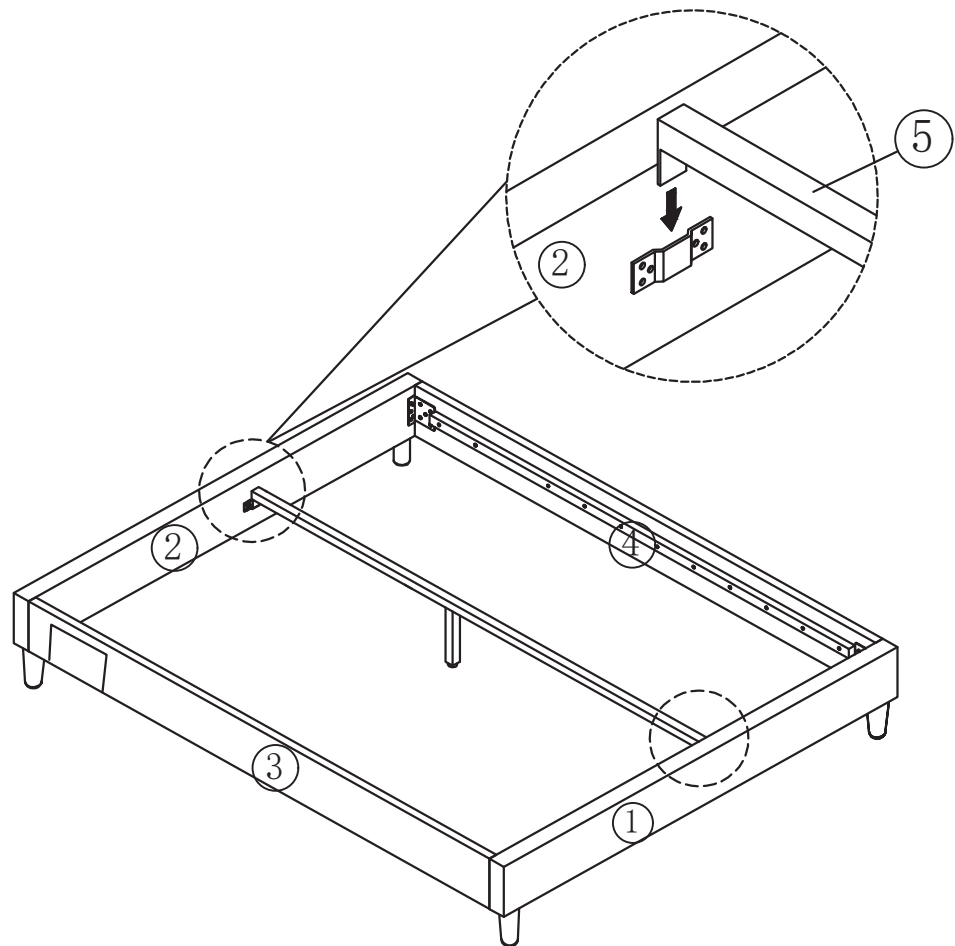

## Step-6

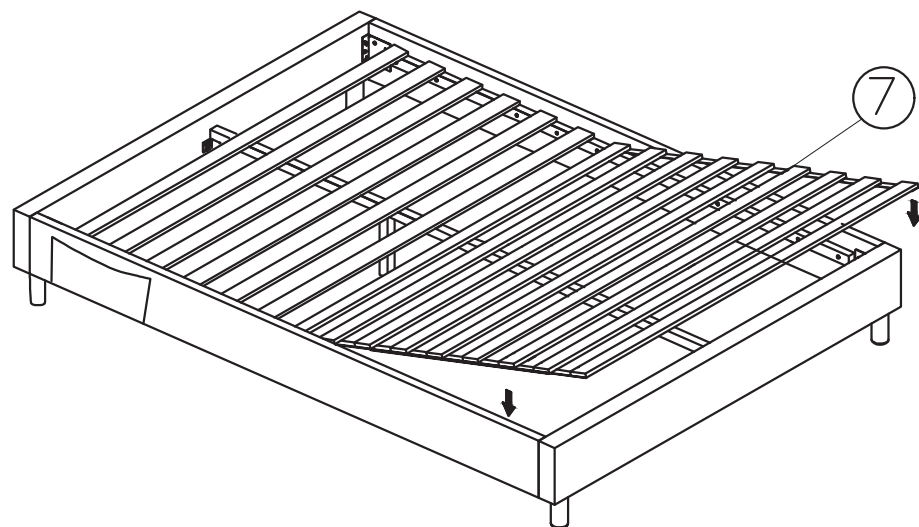

## Step-7

