

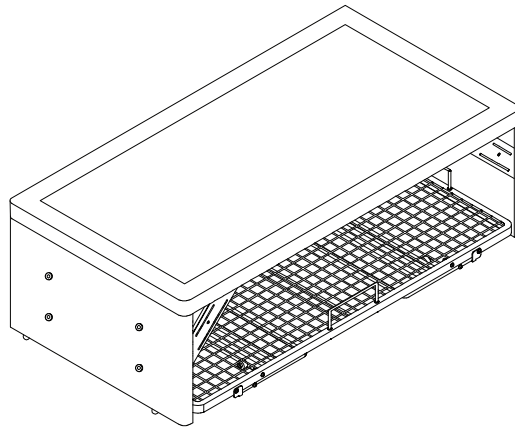

## MODEL : SERENE TRUNDLE BED



KING SINGLE

### PART LIST

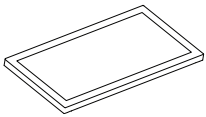

A-UPHOLSTERED BED  
X 1PCS

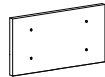

B-HEADBOARD PANEL  
X 1PCS

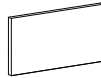

C-FOOTBOARD PANEL  
X 1PCS



D-METAL BASE X 1PCS



E-CORNER BRACKET  
X 2PCS



F-MATRESS STOPPER  
X 4PCS

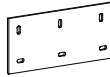

G-SIX HOLE LINKAGE  
PLATE X 4PCS



H-ADJUSTABLE GLIDER  
X 4PCS



I-M6 X 20MM  
X 32PCS



J-SPRING WASHER  
X 8PCS



K-FLANGE NUTS  
X 8PCS



L-ALLEN KEY M6  
X 1PCS



M - STARBOLT X 4PCS

#### 1- ATTACHING ADJUSTABLE TO THE BED STAND

CAREFULLY UNPACK ALL ITEMS FROM THE CARTONS.  
You will need a standard screw driver

Step 1- Screw the adjustable glider (H) to the Bed Stand Bottom B & C.

##### Step 1

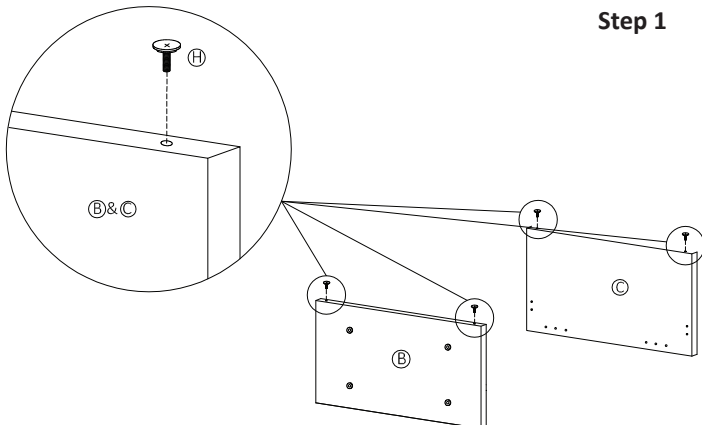

#### 2- ATTACHING BOLT TO SIX-HOLE PLATE

Step 2- Choose which side of the wooden bed base you would like to have the bed against the wall. Attach bolt(I) to six hole plate (G).  
Repeat the same step to other side.

##### Step 2

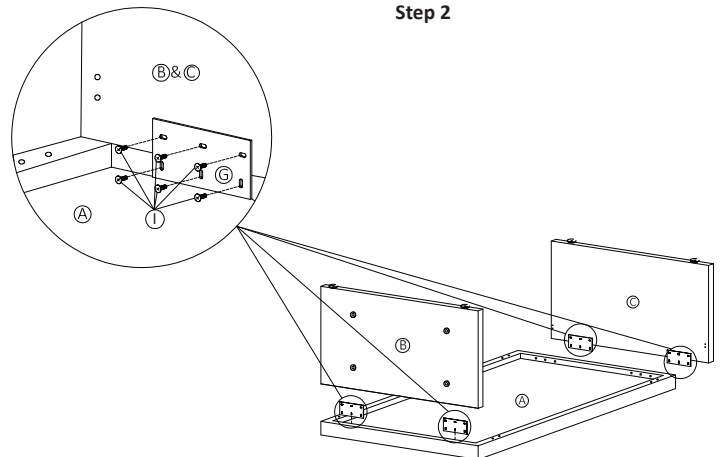

### 3- ATTACHING BOLT TO CORNER BRACKET

Step 3- Connect Corner brackets(E) with bolt(I) and spring washer (K) on the side that is going to be placed against the wall (as illustrate)

Repeat the same step to other side.

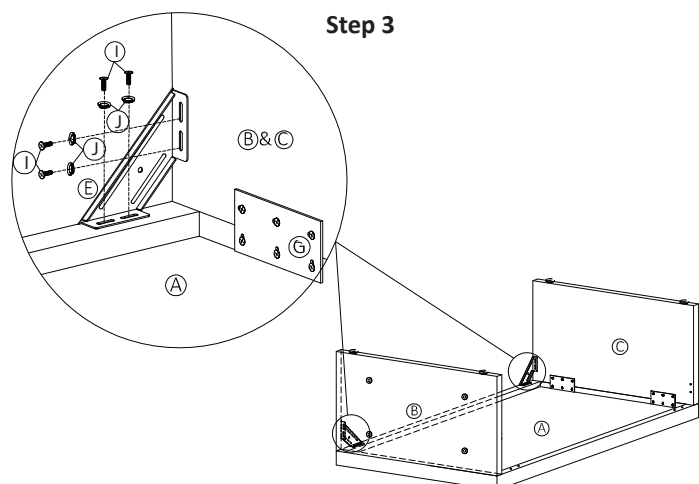

### 4- TURN THE BED

Step 4- Then flip the trundle.

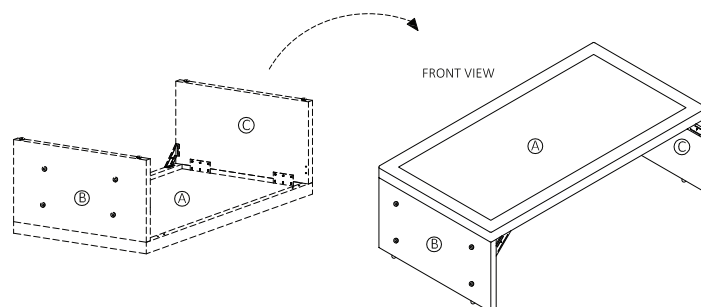

### 5- ATTACHING HANDLE TO METAL BASE

1- Fix the mattress stopper (F) to the metal base with flange nuts(K). Repeat the same step to each side.

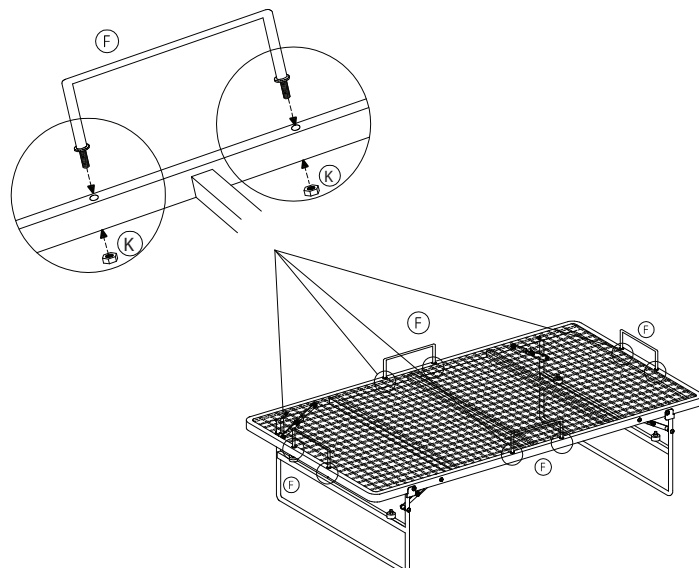

### 6- CLOSED OR OPEN

1- When closed, loosen the hinges (reference no. 1 & 3)  
2- When open, open the hinges to full extension (reference no. 2)

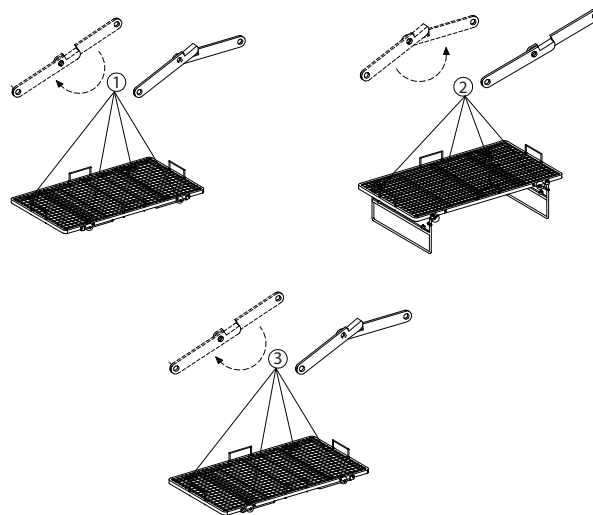

Please mind your hand when the mechanism closed or open.

### 7- SLOT IN THE METAL BASE

1- Slot in the metal base under the trundle carefully.

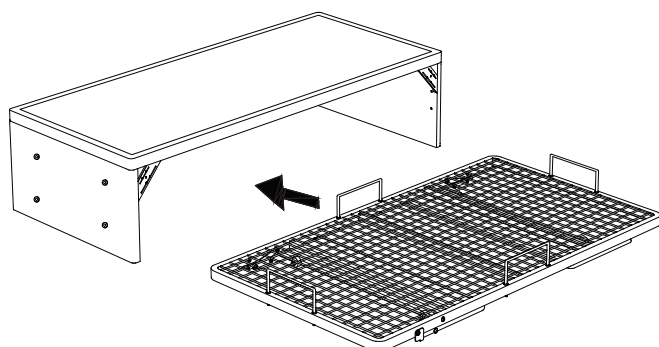

### 8- METAL BASE SITS IN PLACE UNDER TRUNDLE

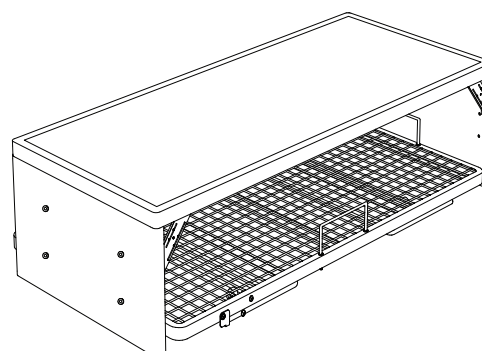

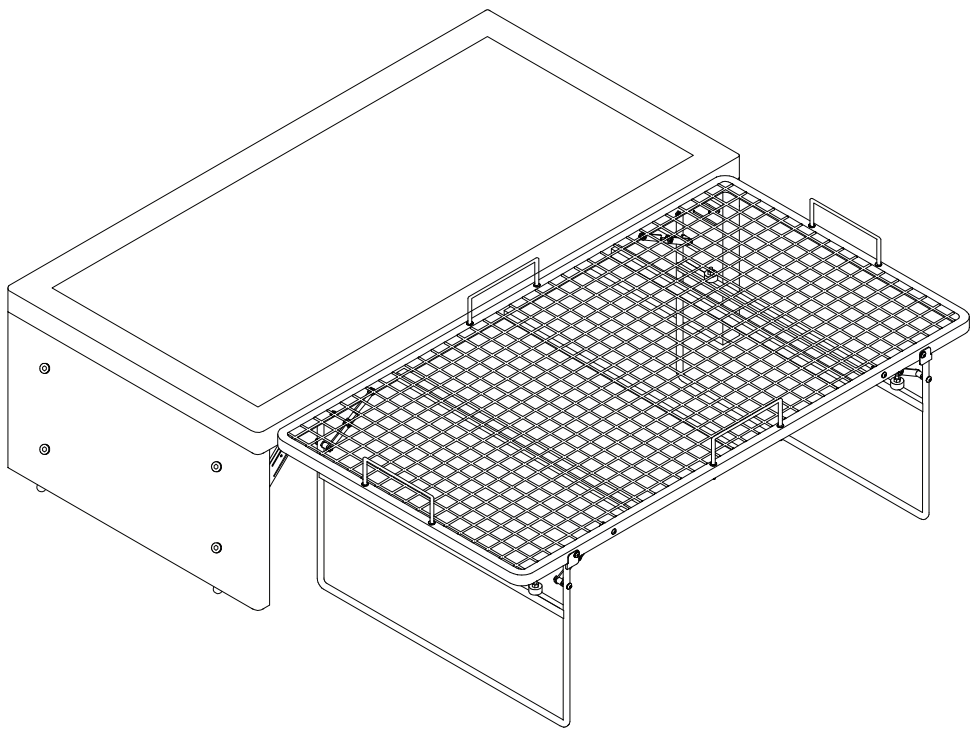

OPTIONAL

Insert the star bolt into the Optional Headboard Panel & Headboard Panel (B).

