

TIPS

- 1 Please review all parts and hardware before disposing of any packaging.
- 2 Check to be sure that all parts and hardware are complete before you start assembly.
- 3 Before beginning assembly, separate each type of screw.
- 4 **Using a screw that is too long will cause damage.**
- 5 Carefully study the screw diagrams below.
- 6 You may receive extra hardware with your unit.
- 7 Place all parts on a clean and smooth surface to avoid the parts from being scratched.
- 8 Keep the product away from heat and humidity.
- 9 Light blue stains and natural wood knots on the product are not considered defects.
- 10 Before start assembly, please categorize the hardware.

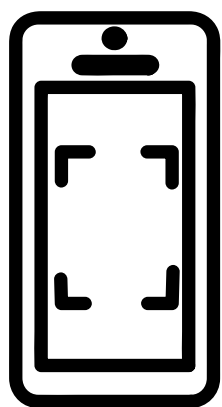

SCAN ME

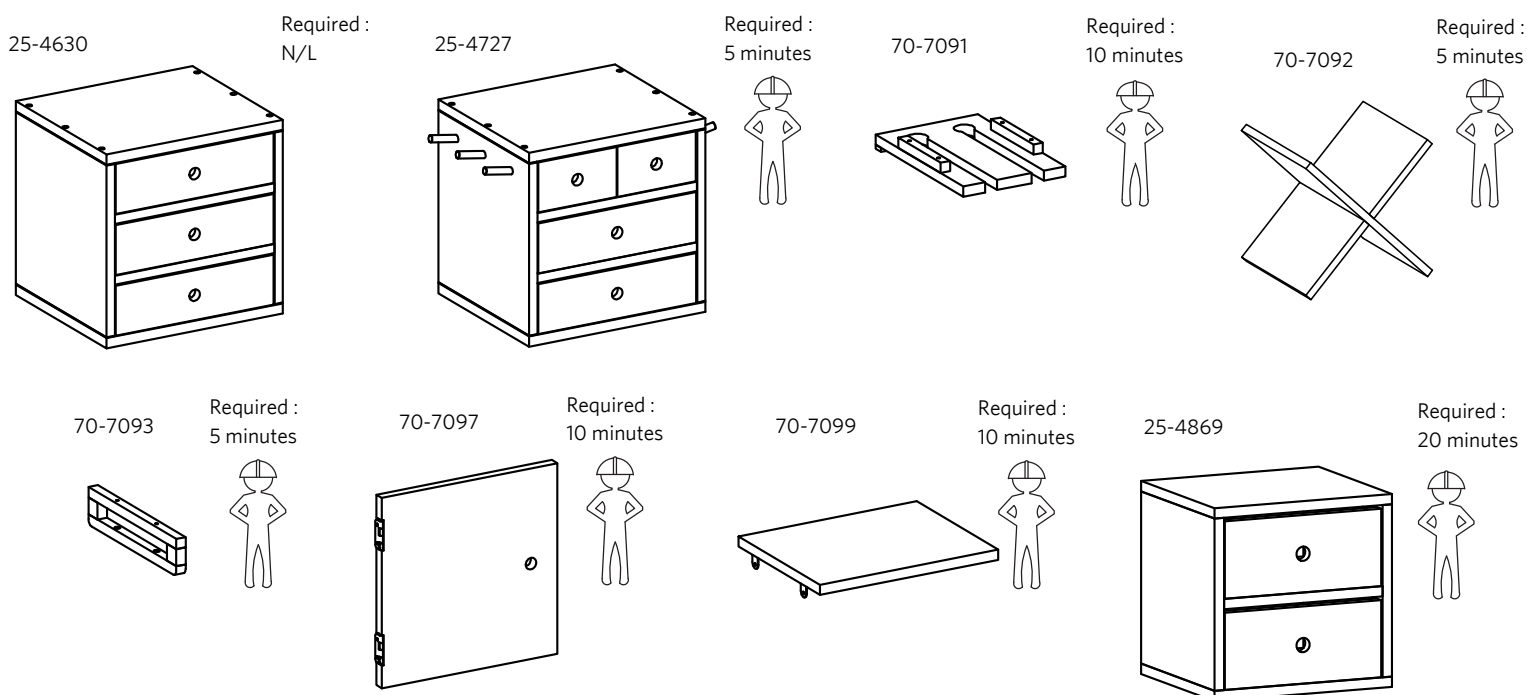

For Step-By Step Real
Photo Assembly Instructions.

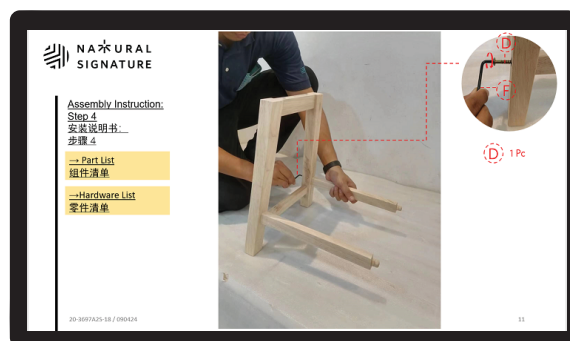

ASSEMBLY INSTRUCTIONS

1 25-4630 Small 3 Drawers

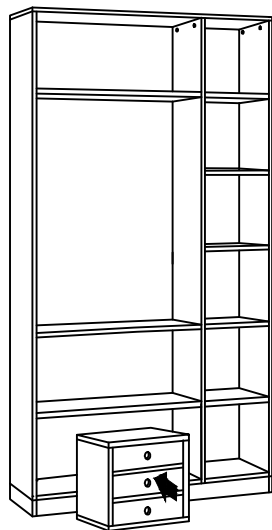

2 25-4727 Magic Box

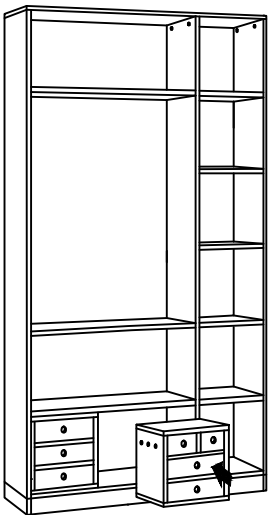

OPTIONAL VIEW

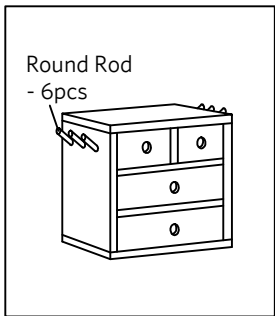

3 70-7091 Wine Glass Hanger

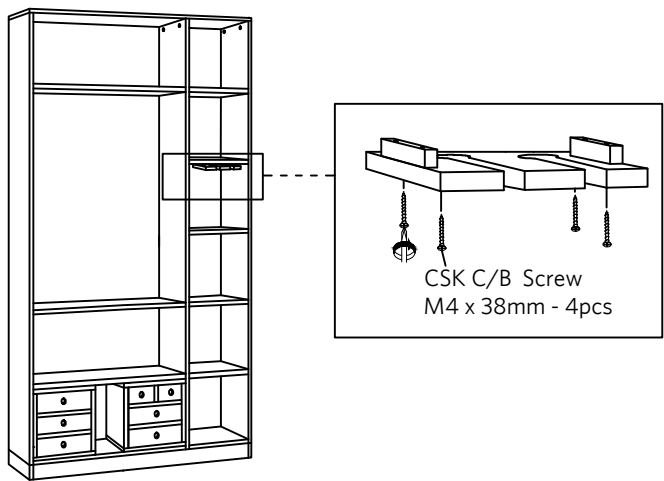

* Repeat for assembly second Wine Glass Hanger.

4 70-7092 X Wine Holder

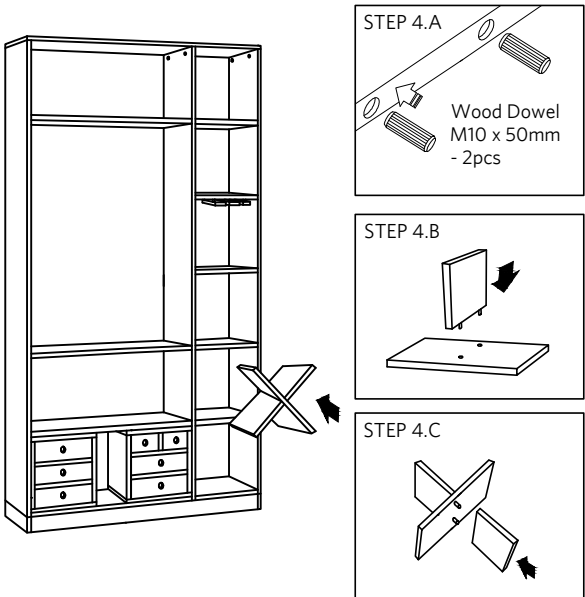

ASSEMBLY INSTRUCTIONS

5 70-7093 Handle Hanger

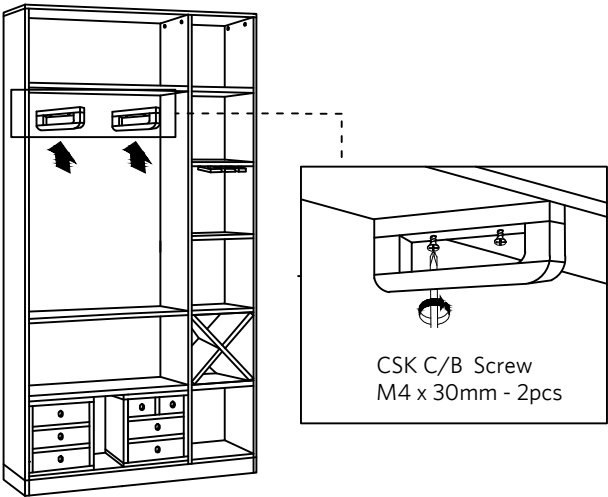

* Repeat for assembly second Handle Hanger.

6 70-7097 Door Panel

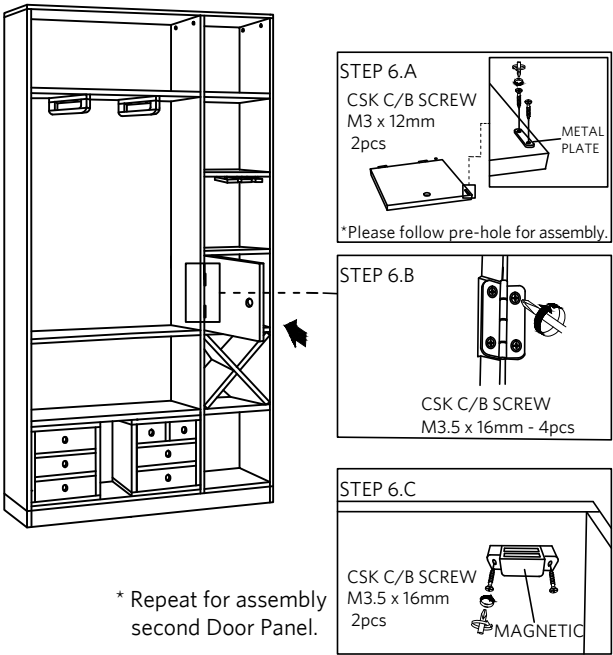

* Repeat for assembly second Door Panel.

7 70-7099 Shelf Panel

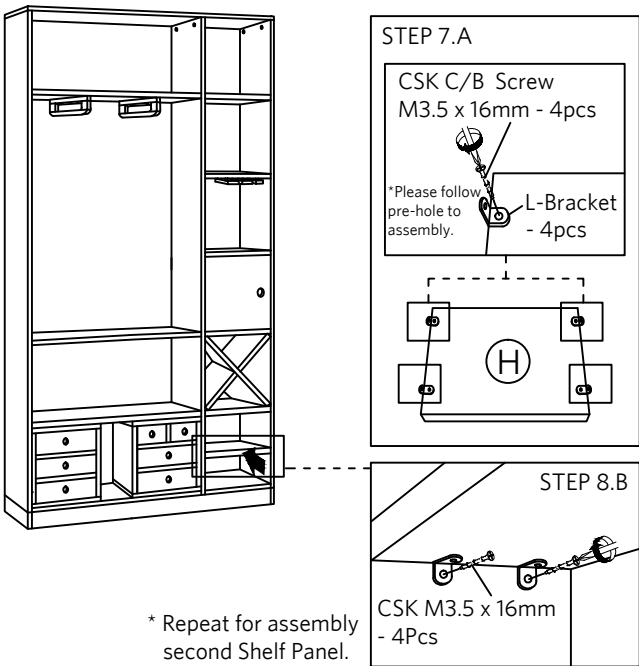

* Repeat for assembly second Shelf Panel.

8 25-4869 Small 2 drawer

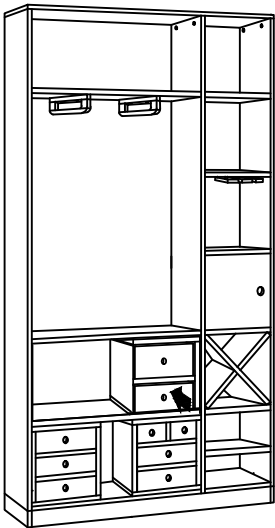

* Please refer to AI -4869 for the assembly steps.