

ASSEMBLY INSTRUCTIONS

SKU 69112-69113-69114-69115

Please read through the following instructions before beginning assembly
Check the parts list and lay out on a soft surface before assembling. Check for any damage.

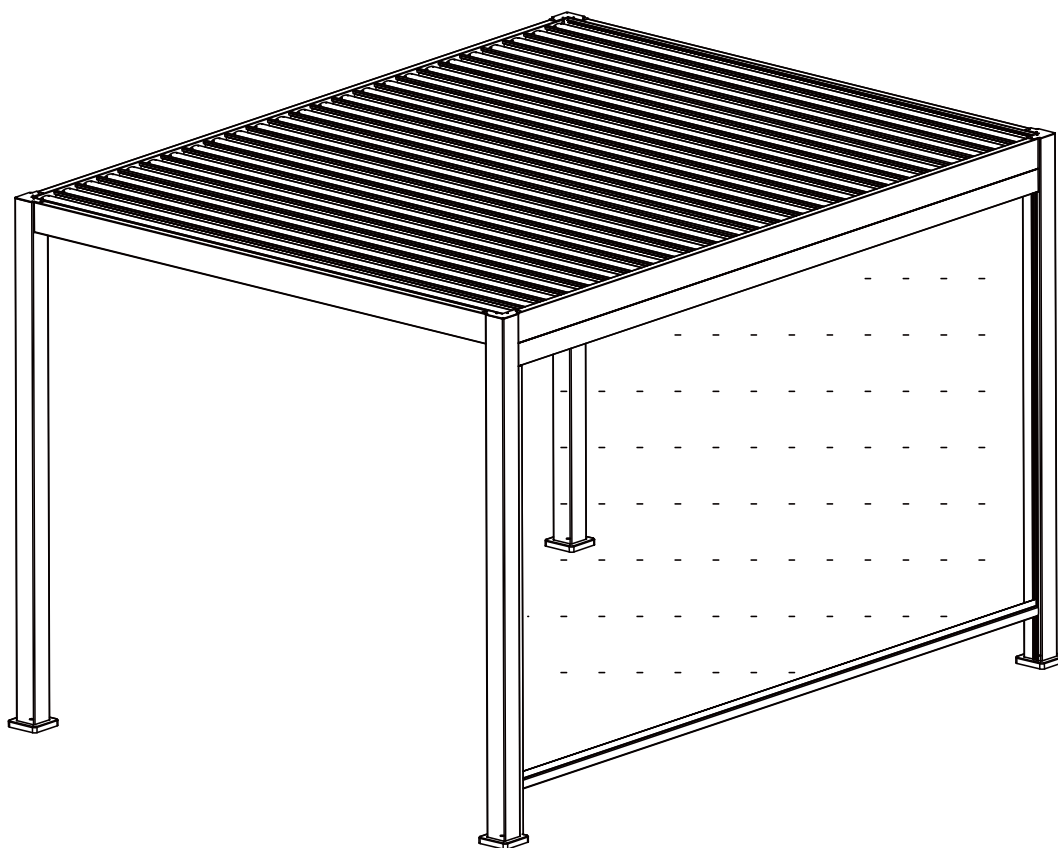

Read manual fully before assembling. Keep instructions safe for future reference.
Not intended for commercial use.

WARNING

1. Installation should be carried out on a flat surface of at least 5 meters * 5 meters, and soft protective pads should be placed on the parts that come into contact with the ground to prevent scratches on the product surface!
2. After unpacking, check the quantity of components according to the parts list;



A 1X



B 2X



C 2X



D 2X

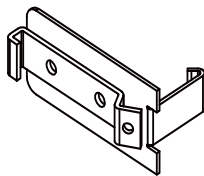

E 3X

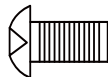

1 M5*14 3X



2 M5*8 3X



3 M5.5*20 6X

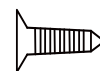

4 M3*12 6X

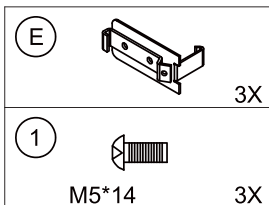

Step 1 Attach assembly plates to the underside of the beam on the Gazebo on the side to match the length of the screen and where you require

STEP 1

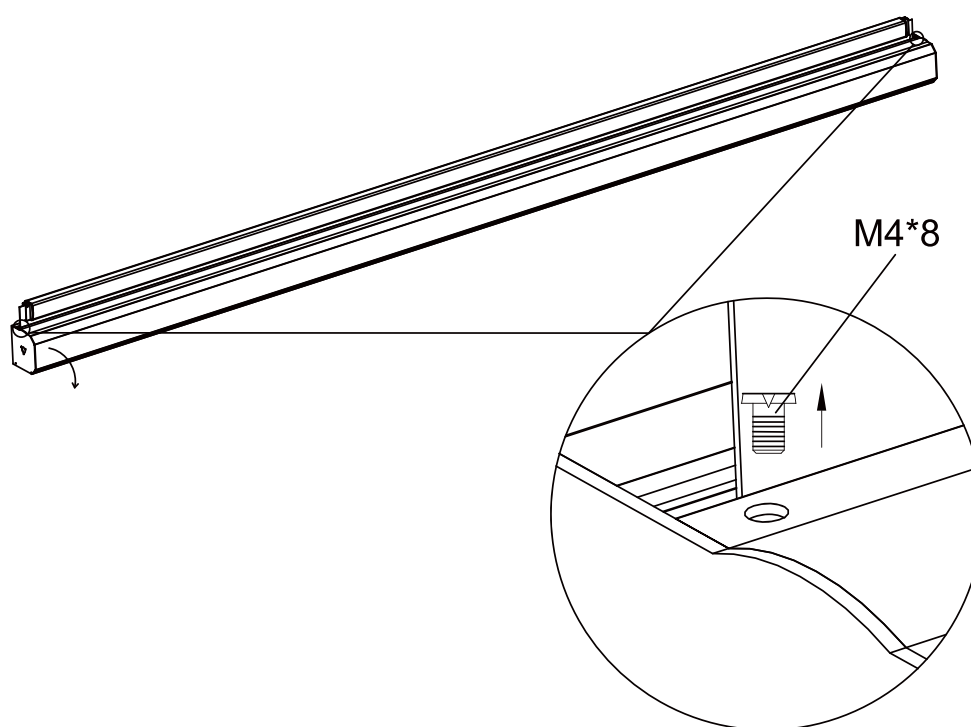
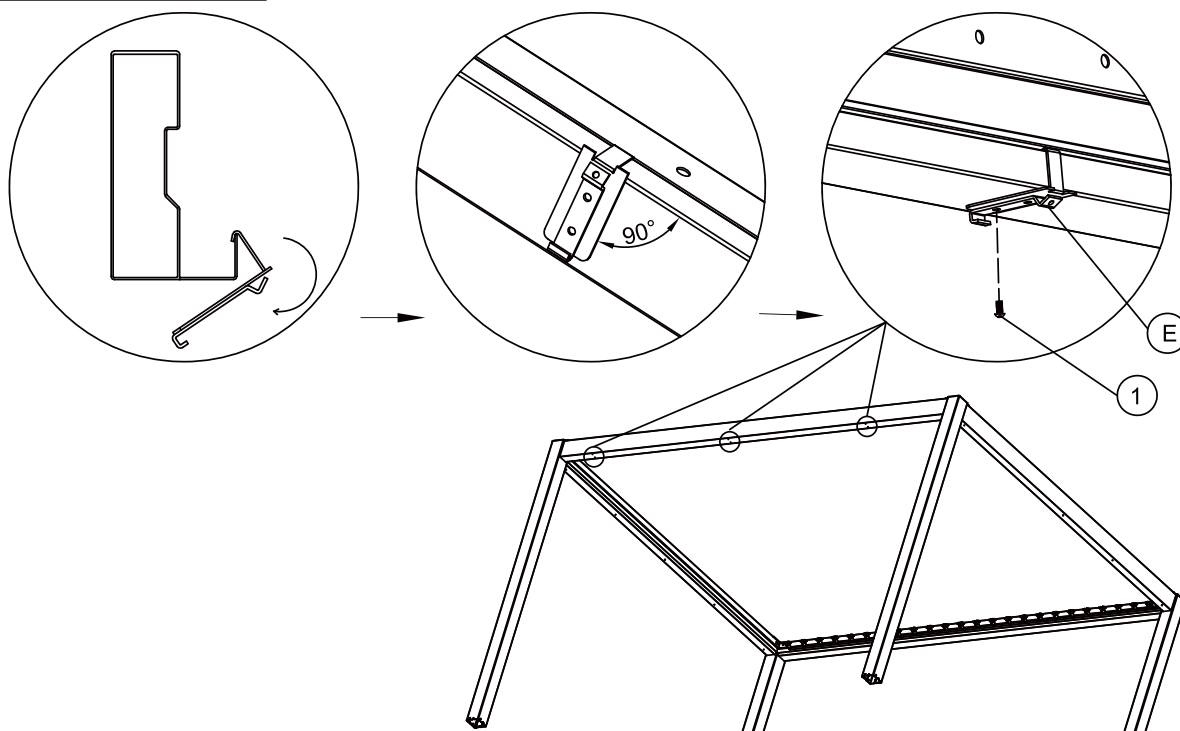

Remove the fixing screws M4*8 on both ends of the cover

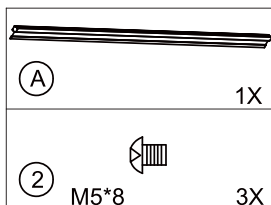

1. Fasten the curtain A on the hanging plate E;
2. Instal M5*8 screws at an angle.

STEP 2

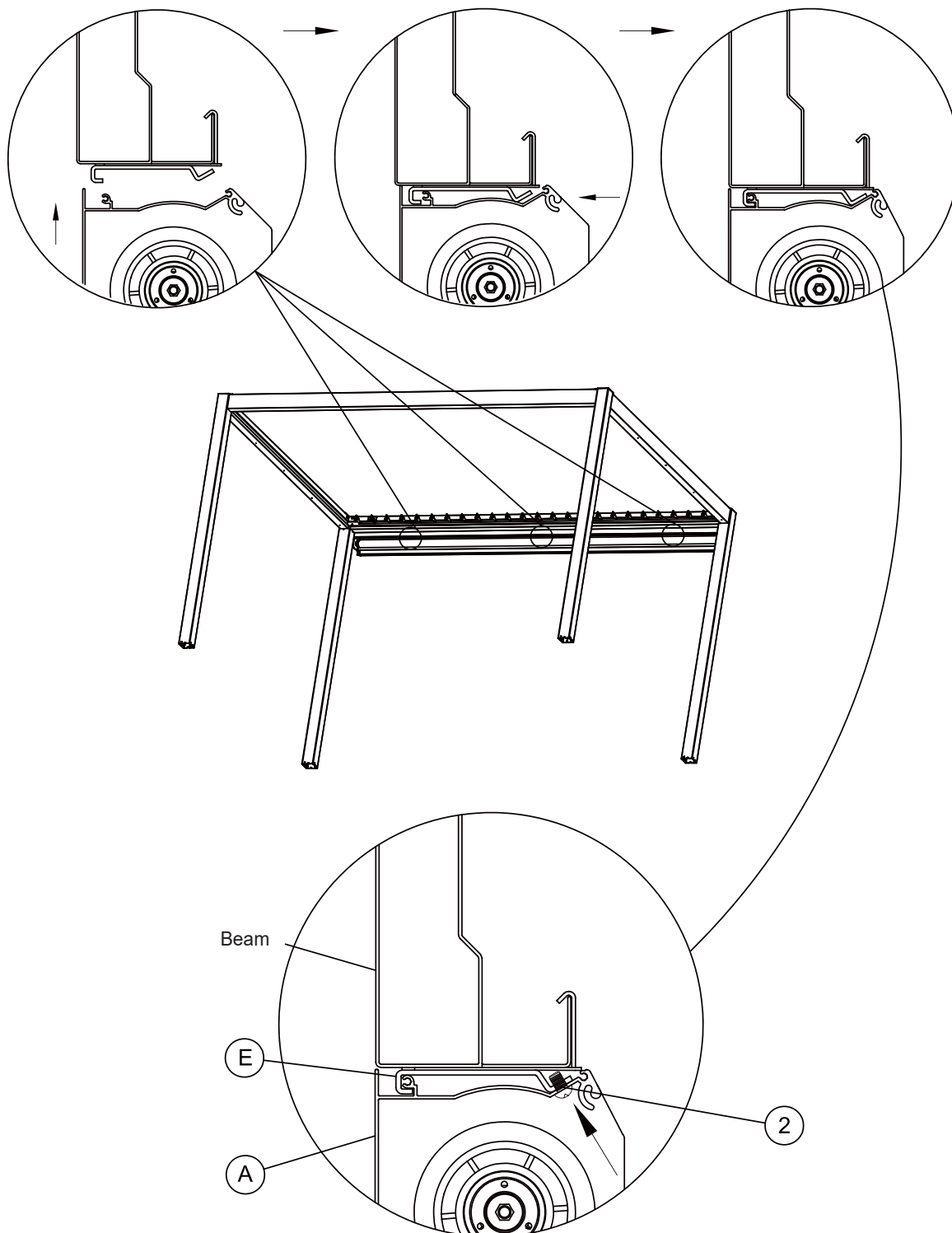

1.Install removable cap

STEP 3

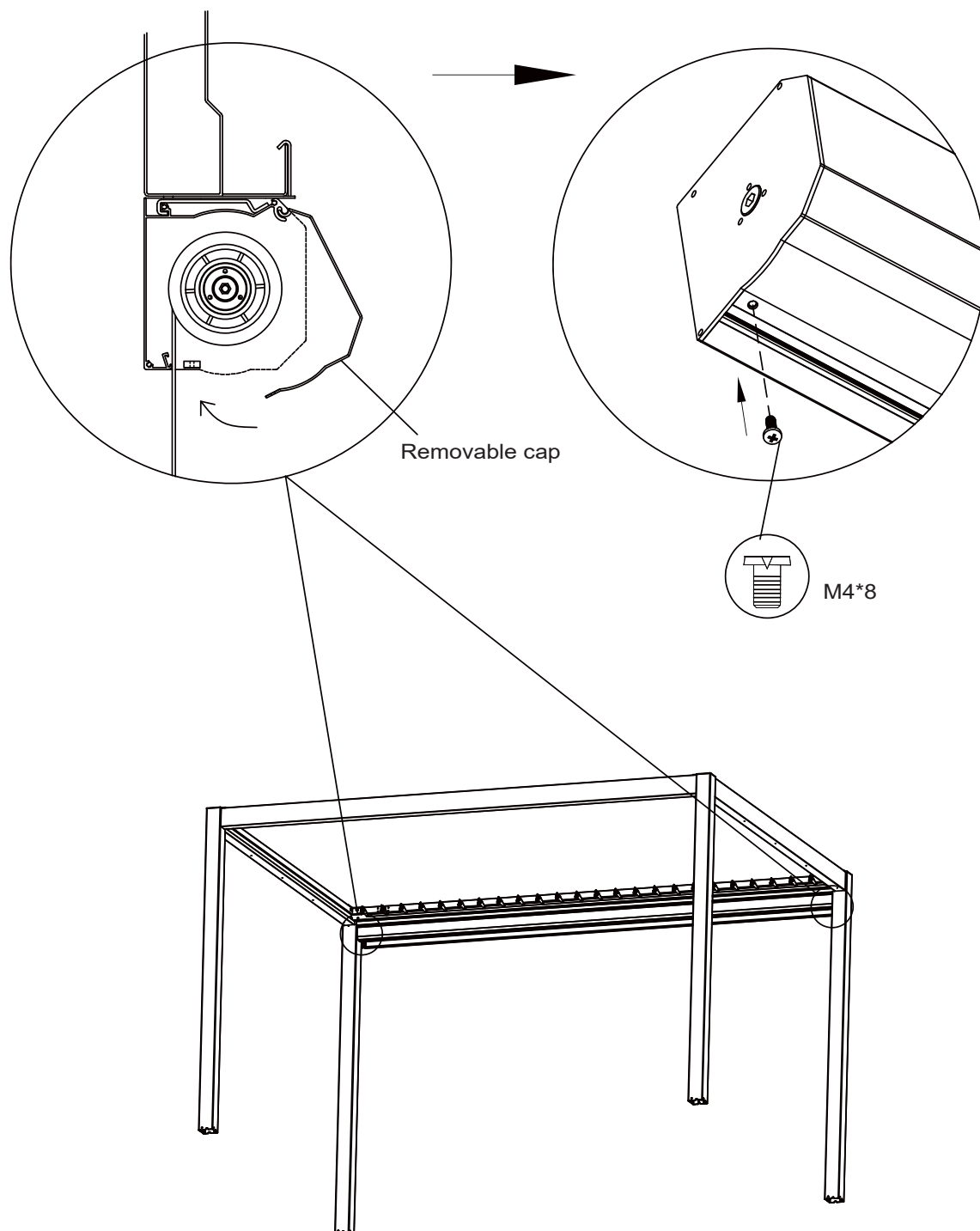

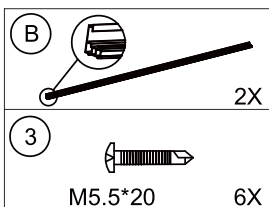

Install outerguide rail B on both side of curtain

STEP 4

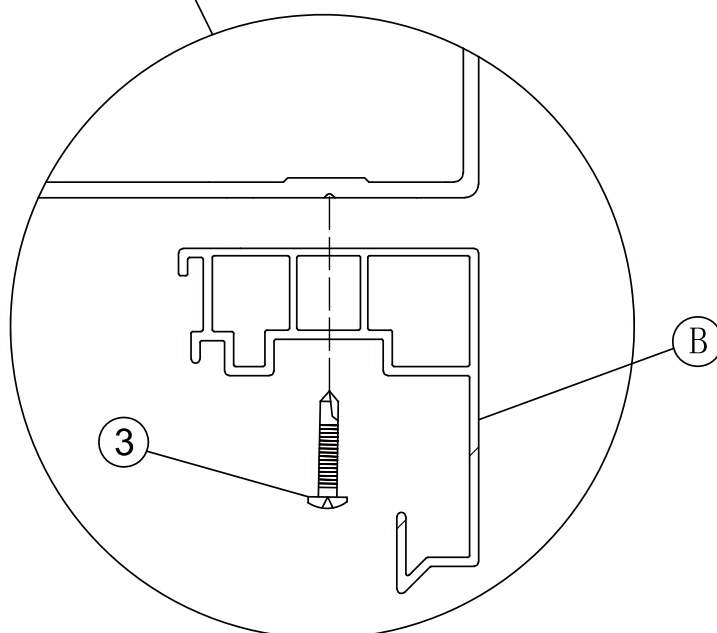
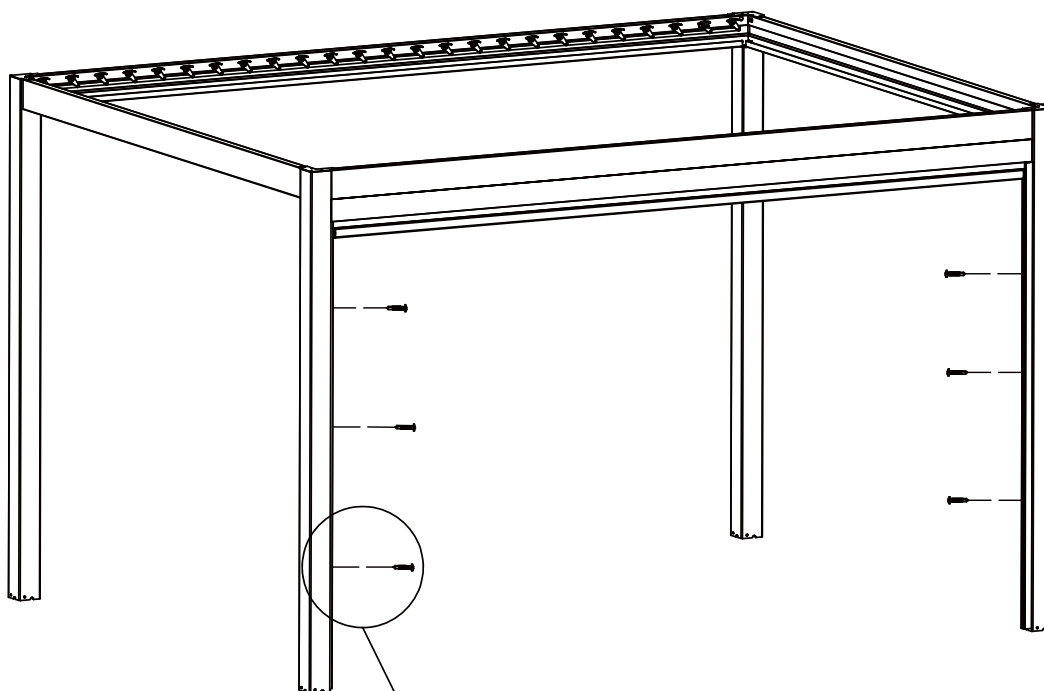

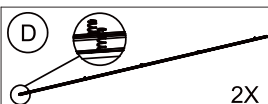

Install slot D on both sides of curtain
Ensure card slots on both sides of the
curtain are installed well, then follow
next step.

STEP 5

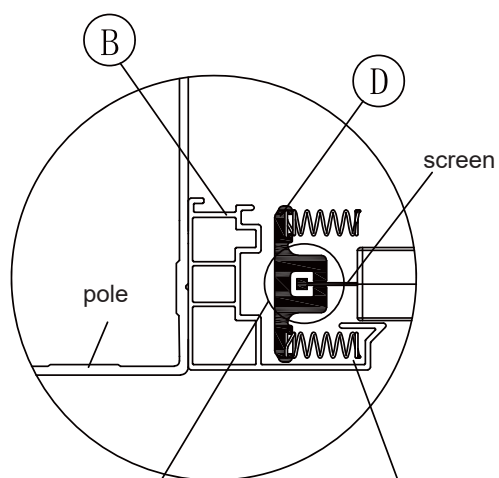
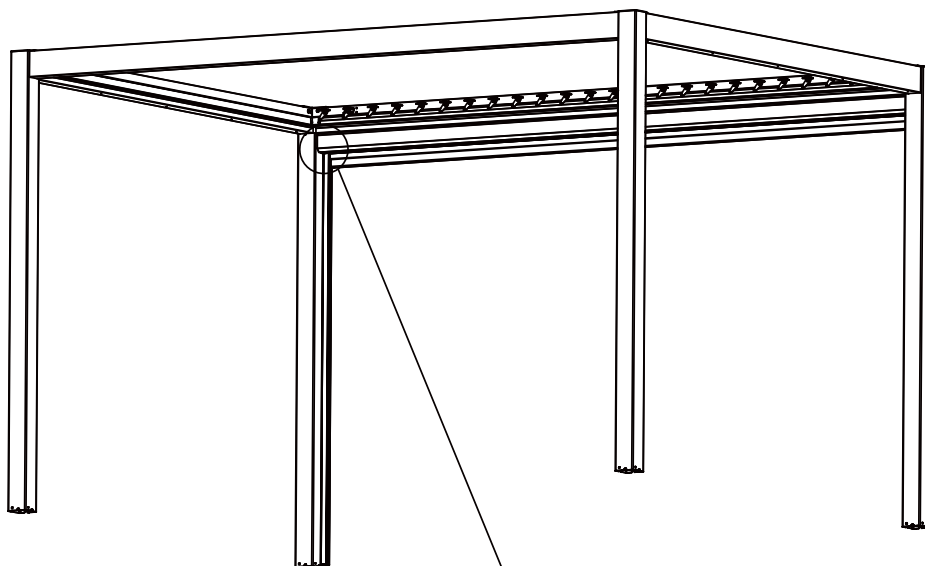

Zipper should
be placed into
the groove of
card slot

Note that once
installed, make
sure that the spring
is also in the
recess shown

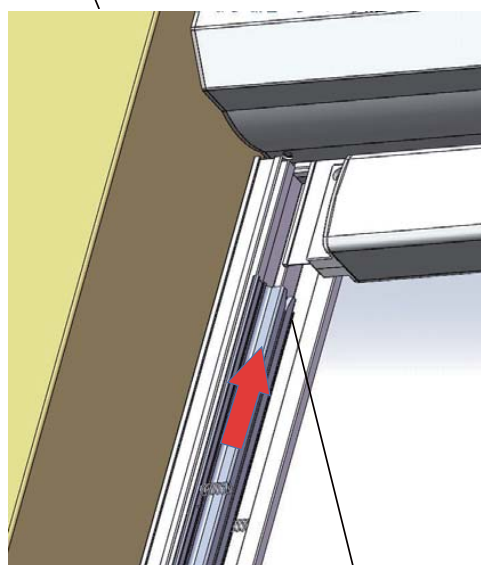

V-shaped
opening face
up

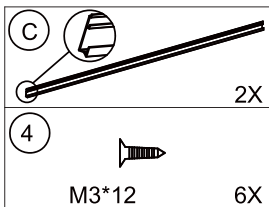

Install side-panel tube C

STEP 6

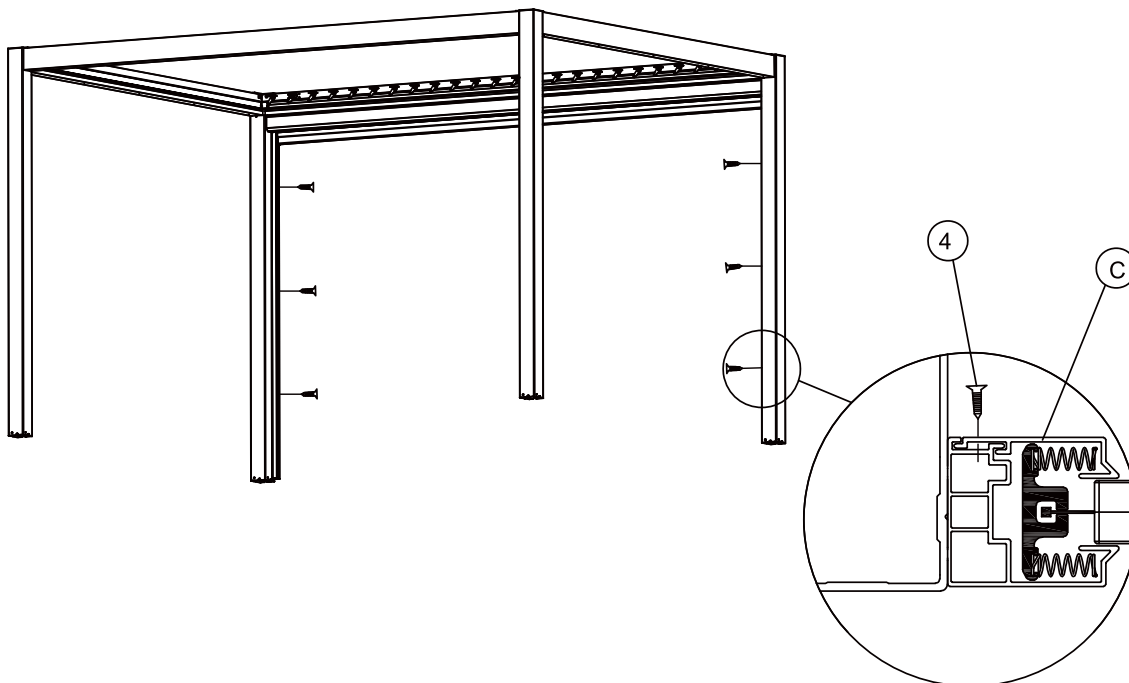

Try pulling the curtain

